

FLEX-FOOT CHEETAH®



A true champion – The only prosthetic foot that has ever run the Olympics.

The Cheetah was the first sport foot of it's kind when first launched in 1996. Ever since the Cheetah has been the foot of choice for athletes around the globe.

Cheetah is recommended for longer distance running for TT users that do not have clearance for Flex-Run with Nike Sole. For sprinting the new Team Össur favorites, Cheetah Xtreme and Cheetah Xtend are recommended.



USER INFORMATION	
Amputation Level:	Transfemoral and Transtibial
Impact Level:	Extreme
Maximum Patient Weight:	147kg (325lbs)



PROPORTIONAL
RESPONSE



ACTIVE TIBIAL
PROGRESSION

FOOT INFORMATION	
Categories:	1-9
Sizes:	One Size Per Category
Weight of Foot:	512g (18.1oz)
Build Height:	411mm (16 3/8")
Adapter Options:	Lamination Connector or Pylon Connector

CATEGORY SELECTION CHART

WEIGHT KG	45-52	53-59	60-68	69-77	78-88	89-100	101-116	117-130	131-147
WEIGHT LBS	97-115	116-130	131-150	151-170	171-194	195-220	221-256	257-287	288-325
Extreme Impact Level	1	2	3	4	5	6	7	8	9

FLEX-FOOT CHEETAH®

CLEARANCE

WITH LAMINATION CONNECTOR

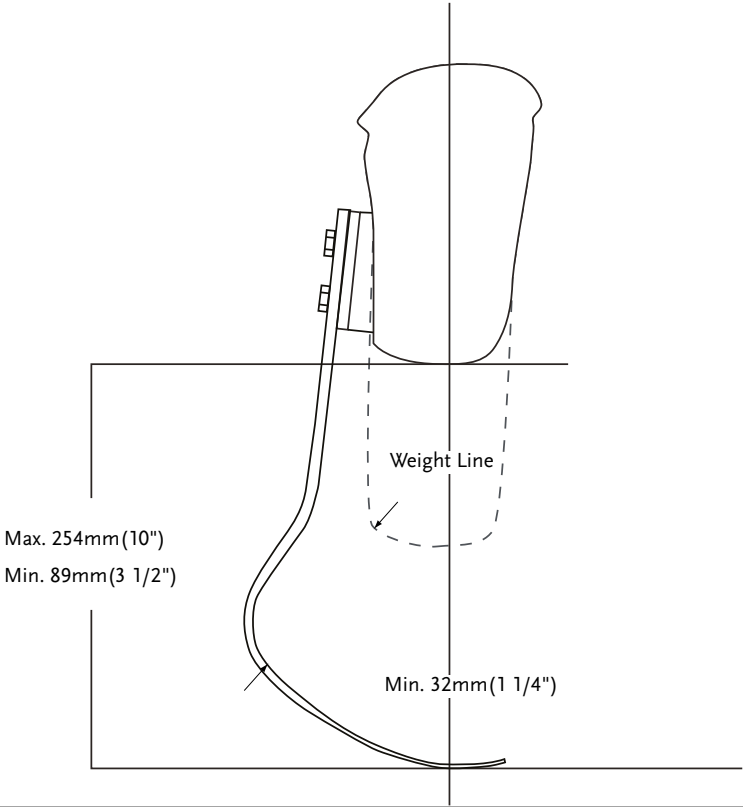

KITS

CHEETAH KIT

PART#	CATEGORY (1-9)
FSX004	

Note: Cheetah is a special order and is excluded from the trial period.

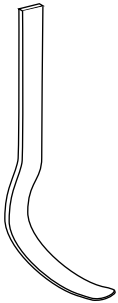

FLEX-FOOT CHEETAH®

KITS

PICTURE	PART#	DESCRIPTION	CAT.
1.	FSX50001	Lamination Connector	1-6
	FSX50002	Lamination Connector	7-9
2.	FSX50003	Pylon Connector	1-6
	FSX50004	Pylon Connector	7-9

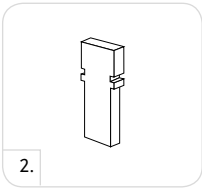
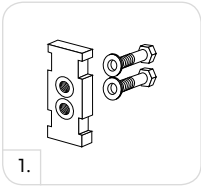

- Includes:
- Connector
 - Alignment Wedges (2°, 4°, 6°, 8°)
 - Attachment Hardware
 - Lamination Kit

PICTURE	PART#	DESCRIPTION	SIZE	CAT.
1.	CM130218	Attachment Bolt for Lamination Connector	5/16"-24 x 1 1/2"	1-6
	CM130213	Attachment Bolt for Lamination Connector	3/8"-24 x 1 3/4"	7-9
2.	CM130305	Attachment Bolt for Pylon Connector	5/16"-24 x 1 1/2"	1-6
	CM130304	Attachment Bolt for Pylon Connector	3/8"-24 x 1 3/4"	7-9

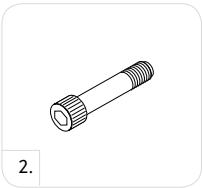
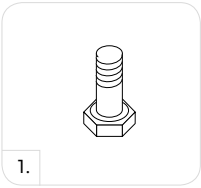

HARDWARE KIT FOR T CONNECTORS

PART#	LENGTH	WEIGHT	SIZE	CAT.
CM100054	8mm	5/16"	108g 3.8oz x 2-1/2"	1-6
CM100055	10mm	3/8"	144g 5oz x 2-1/2"	7-9

- Includes:
- Bolts
 - Nuts
 - Spherical Washer
 - Flat Washer

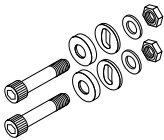

PART#	DESCRIPTION	CAT.
CM140502	Alignment Wedges 2°	ALL
CM140505	Alignment Wedges 4°	ALL
CM140508	Alignment Wedges 6°	ALL
CM140511	Alignment Wedges 8°	ALL

