

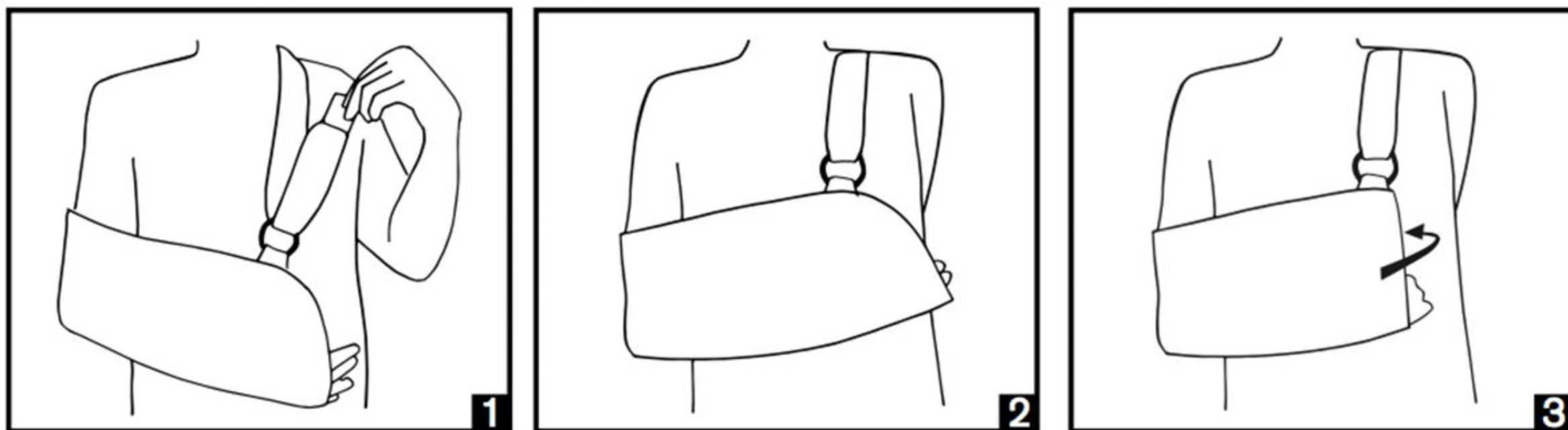

INSTRUCTIONS



Place elbow in the sling pocket. Bring strap over the opposite shoulder and feed through the D-ring. Pull the strap up so that hand is slightly above elbow. To adjust length of envelope, fold inward to desired length and attach.

| |
|----------|
| ONE SIZE |
| 10.5-18" |
| 27-46 cm |

